

Here's what you'll need to set up your



- AT&T TV package
- Your home Wi-Fi® network name and password, or an ethernet cable for a wired connection
- Access to an HDMI port on your TV
- AT&T TV sign in info

**AT&T USER ID**

**AT&T PASSWORD**

If you have a temporary password, create a permanent one before getting started.

 It's easy when you download the **AT&T TV app**

or

Go to [www.att.com/my](http://www.att.com/my) and sign in using your temporary credentials.

Need help? Check out [www.att.com/TVwelcome](http://www.att.com/TVwelcome) for support, FAQ, live chat, and a helpful instructional video demonstrating the steps below.

## Let's Get Connected



- 1 Open the AT&T TV package**  
It should have an AT&T device, remote, power supply, and HDMI cable inside.

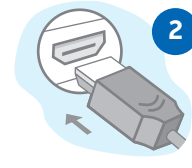

- 2 Plug either end of the HDMI cable into the device.** Make sure it's oriented correctly. Now plug the free end of the HDMI cable into an HDMI port on your TV set (usually found on its side or back).

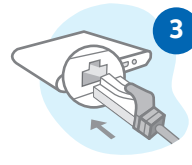

- 3 Using an ethernet cable?**  
Connect it now. An ethernet connection will deliver the best experience. If you're using Wi-Fi, go to Step 4.

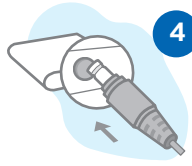

- 4 Plug the round end of the power cord into the device.** Now plug it into an electrical socket. The device's colored lights should turn on.



- 5 Turn on your TV with its remote.**  
You may need to tap the "input" button on your TV remote to get the AT&T TV signal.



- 6 Get the AT&T TV remote. Gently remove the battery tag.**  
You'll use this remote for the rest of setup.



- 7 Follow the onscreen prompts** to complete setup. You'll need your AT&T TV ID and password, Google ID and password (if you have one), and your home wifi network credentials (if you're not using ethernet).